

Join us for the 90th

# LMEA PROFESSIONAL DEVELOPMENT CONFERENCE

NEW ORLEANS, LA | HILTON RIVERSIDE | JANUARY 17-20, 2026

## EXHIBITOR INFORMATION

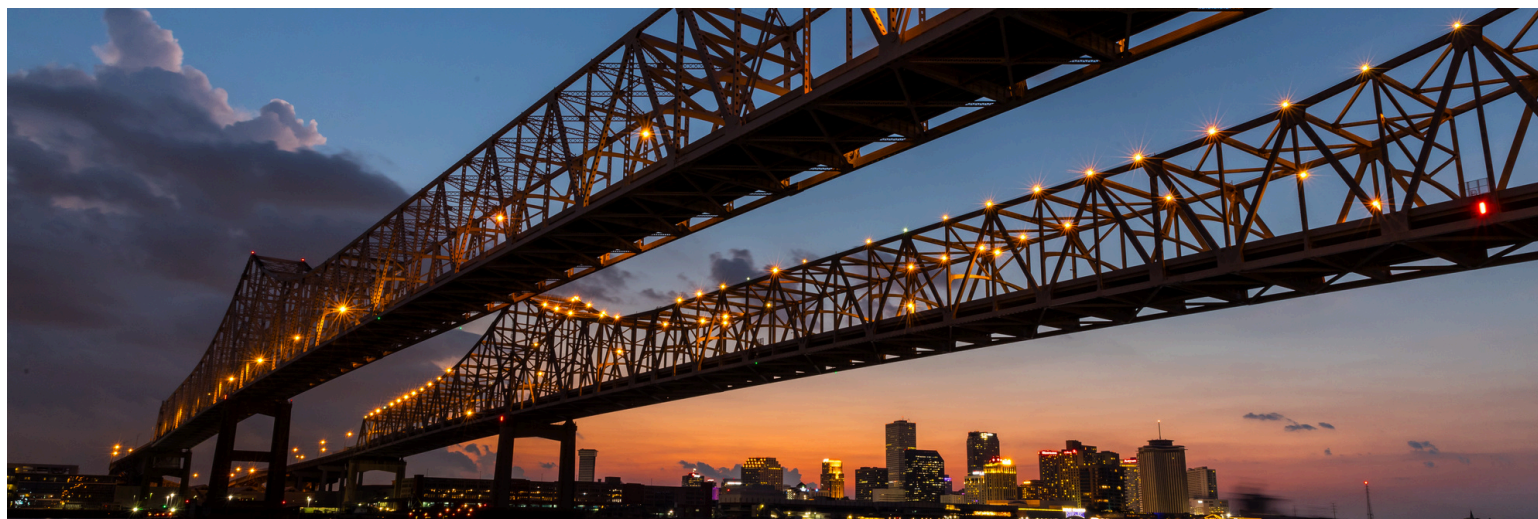

## JOIN OUR EXHIBITOR KREWE!

The Louisiana Music Educators Association would like to invite you to exhibit at our 2026 Professional Development Conference in New Orleans! Our newly expanded conference welcomes more students, families, teachers, and administrators than ever before, offering the experience of a true regional convention in the Gulf South! We've also made changes to our exhibitor schedule and logistics following our successful 2025 conference to make your experience even better!

In this day of electronic communication, many companies, colleges, non-profits, and military branches are realizing the importance of face-to-face communication. This Conference will offer you an opportunity to interact with our membership—both music educators and collegiate members—as well as parents and student members at the high school and middle school levels of the Louisiana All-State Choirs, Bands, Orchestra, Guitar Ensemble, Jazz Ensemble, and Handbell Choir.

Whether your goal is to gain new customers, recruit, build relationships, or you simply want to stay in contact with your current clientele, the LMEA Professional Development Conference is a great value for your time and money!



### WANT TO LEAVE A LASTING IMPRESSION?

Make sure your brand is on everyone's mind with thousands of daily impressions by underwriting attendee lanyards or advertising on the conference wi-fi splash page! Contact Joshua Stearman for more information!



### MORE ATTENDEES

The LMEA Conference welcomes over 1500 attendees including students, parents, teachers, and administrators from Louisiana and across the Gulf South.



### AFFORDABLE

Booths start at \$450, introducing you to a clientele who typically hasn't attended a regional convention. Exhibitors also have access to our special hotel pricing at the Hilton Riverside!



### PARTNERSHIPS AVAILABLE

Show your support for music education in Louisiana by partnering with LMEA by sponsoring student meals, internet service, signage, or spotlight your brand with a clinic!

#LMEANOLA90

[WWW.LMEAMUSIC.ORG](http://WWW.LMEAMUSIC.ORG)

## EXHIBIT PACKAGES

	Premier Exhibitor	Exhibitor Plus	Exhibitor
Location	Exhibit in the heart of the action with an oversized booth located in <b>"The District"</b> . This area is the hub between the clinic spaces, exhibit hall, and several All-State rehearsals.  <b>7 booths available, 8x20</b>	Ensure maximum exposure by purchasing a booth at the <b>entrance to the exhibit hall!</b>  Exhibits will be in the St. Charles Ballroom on the same floor as the clinic spaces and multiple rehearsal spaces.  <b>10 booths available, 8x10</b>	Meet attendees face-to-face in the beautiful <b>St. Charles Ballroom</b> .  Exhibit Space is located on the same floor as the clinic spaces and multiple rehearsal spaces.
Cost	<b>\$1500</b>	<b>\$850</b>	<b>\$450</b>
Acknowledgement as a Premier Exhibitor on LMEA homepage with an embedded link to your website	✓		
Access to host after-hours receptions and events in hospitality suites	✓		
Logo, company profile, and/or company name listed on LMEA Exhibitor page	Logo and Company Profile with embedded link	Logo with embedded link	Company name listed
Social media shoutouts preconference from official LMEA Facebook page	✓		
Priority access to standard electrical wall outlet (limited spots available)	✓	✓	
Ad Placement in color, digital program	1/2 page (arranged horizontally) Upgrade to a full page for \$200	1/4 page (arranged vertically) Upgrade to a half page for \$100 and full page for \$300	1/4 page (arranged vertically) Upgrade to a half page for \$100 and full page for \$300
Conference badges provided	6	4	Commercial/non-profit: 2 Collegiate/Military: 4
Mail & Email List of those that have opted in	✓	✓	

### Deadlines

All registration, payments, and ad copy must be received by **November 1, 2025** to avoid a \$100 late fee.

Additionally, registrations received after **December 1, 2025** may not be included in print and digital branding due to production deadlines.

**No refunds will be given for cancellations.**



# INFORMATION AND GUIDELINES

## DESCRIPTION OF SPACE

- **Exhibitor and Exhibitor Plus:** Each space consists of an 8x10 floor space; 8' high back and 3' high side drape; one (1) six-foot table with tablecloth and skirt; two (2) chairs, wastebasket, and a 7" x 44" one-line booth ID sign.
  - Please see price list for the number of badges provided per booth. Each badge will be assigned to an individual working your booth. Badge sharing is prohibited. Extra badges can be purchased ahead of time or at the registration table.
- **Premier Exhibitor:** Each space consists of 8x20 floor space; two (2) six-foot tables with tablecloths and skirts; four (4) chairs, and wastebasket.
  - LMEA will provide up to six (6) name tags. Each badge will be assigned to an individual working your booth. Badge sharing is prohibited. Extra badges can be purchased ahead of time or at the registration table.

Arrangements for drayage, additional tables, furnishings, or other equipment are not the responsibility of LMEA and must be made directly with our exhibit hall contractor, Freeman.

Electricity is not included in the package price. Any electricity needs should be contracted through Encore, the AV contractor for the Hilton.

## Load In

Saturday January 17th

## Load Out

Monday January 19th

*The exhibit hall will be open for two days this year*



1/2 Page

1/4 Page

## Logo and Company Profile

When completing the application, you will be asked to upload your company logo (.PNG, JPEG, EPS or Vector files), and a brief company profile (75 words or less).

## Included Program Ad Specifications

### Ad specs:

- Bitmap Graphics: JPG, JPEG, or PNG. 300 dpi. RGB color.
- Vector Graphics: Adobe Illustrator, or EPS. All text converted to outlines/curve. RGB color.

### Ad sizes:

- 1/4 page ad: 4.25 X 5.5 vertical layout
- 1/2 page ad: 8.5 X 5.5 horizontal layout
- Full-page ad: 8.5 X 11 vertical layout



#LMEANOLA90

[WWW.LMEAMUSIC.ORG](http://WWW.LMEAMUSIC.ORG)

# LMEA 2026 Conference - Exhibit Hall

January 17-20, 2026

HILTON NEW ORLEANS RIVERSIDE - LEVEL 3 - NEW ORLEANS, LOUISIANA

St. Charles Ballroom  
47 - 8' X 10' Booths

## ST. CHARLES BALLROOM

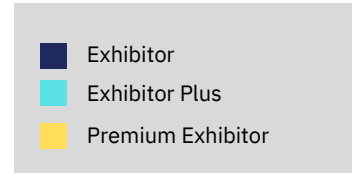
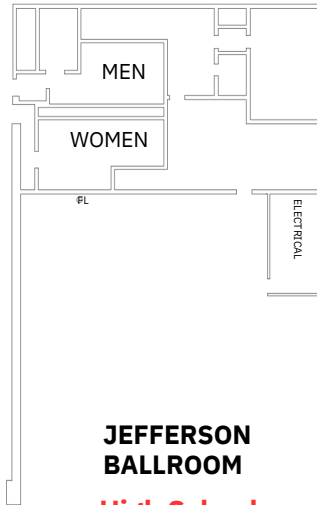

Map not to scale. Subject to revisions.

## ST. JAMES BALLROOM

High School  
Symphonic Band  
Rehearsal

## THE DISTRICT



High School  
Concert Band  
Rehearsal

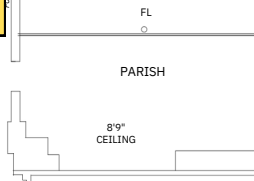

Elevators and Escalators  
from 1st and 2nd floors

6 Clinic Rooms

## FULTON

High School Jazz  
Band Rehearsal



WARWICK  
8'5" CEILING

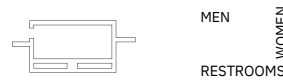

NEW THIS YEAR!

CHECK THE MOST UP-TO-DATE BOOTH  
AVAILABILITY BY SCANNING THE QR CODE AT  
THE RIGHT



#LMEANOLA90

WWW.LMEAMUSIC.ORG



Two Poydras Street ♦ New Orleans, LA 70130  
504-561-0500

LMEA Room Block Rate: \$205/night plus tax  
Discounted Overnight Self Parking: \$20/night

*Access the LMEA discounted room block at  
**[bit.ly/2026LMEAhotel](http://bit.ly/2026LMEAhotel)***

*Discounted room block closes on December 31, 2025.*



**Purchase a booth:**

**[bit.ly/LMEAexhibitor](http://bit.ly/LMEAexhibitor)**



**Questions? email  
[jstearman@lmeamusic.org](mailto:jstearman@lmeamusic.org)**



### **Liabilities and Additional Guidelines:**

- Your booth must be set up and ready to show by exhibit hall opening. Hotel rules dictate certain floor protections and other policies with load in and load out, so we cannot guarantee hall access outside the scheduled load in and out times.
- You, your company's representatives, and all items related to your exhibit must remain within your designated floor space.
- All vendors are required to monitor their noise level and maintain a professionally courteous level.
- LMEA, Hilton New Orleans Riverside, Freeman, nor Encore is liable or responsible for your materials during the conference. The exhibit area is locked, secured, and patrolled by a security guard during non-exhibit hours. The District is not able to be locked, though security will be patrolling the area.
- Do not leave cash boxes or other money unattended in the exhibit area. LMEA, Hilton New Orleans Riverside, Freeman, nor Encore will assume responsibility.

**#LMEANOLA90**

**[WWW.LMEAMUSIC.ORG](http://WWW.LMEAMUSIC.ORG)**