

# LMEA 2026 Conference - Exhibit Hall

January 17-20, 2026

HILTON NEW ORLEANS RIVERSIDE - LEVEL 3 - NEW ORLEANS, LOUISIANA

St. Charles Ballroom  
47 - 8' X 10' Booths

## ST. CHARLES BALLROOM

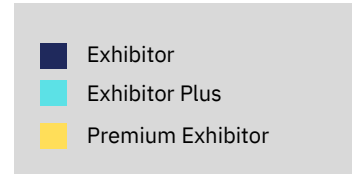
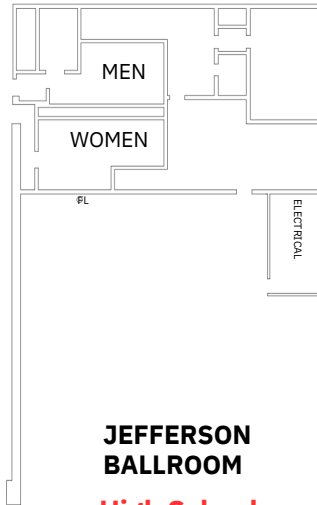
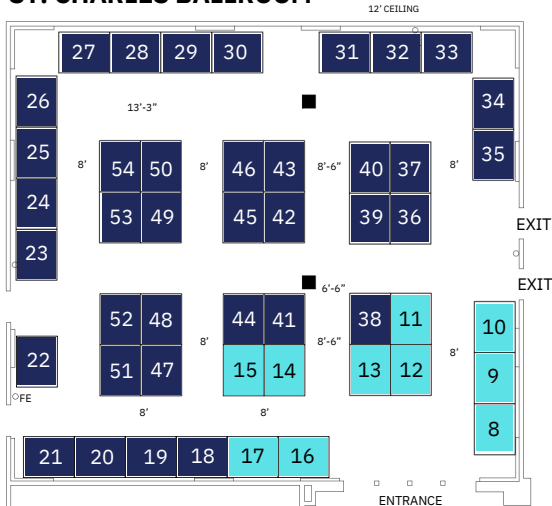

Map not to scale. Subject to revisions.

## ST. JAMES BALLROOM

**High School  
Symphonic Band  
Rehearsal**

## THE DISTRICT

**JEFFERSON  
BALLROOM**  
**High School  
Concert Band  
Rehearsal**

**FULTON**  
**High School Jazz  
Band Rehearsal**

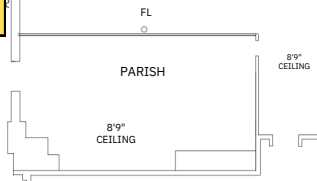

**Elevators and Escalators  
from 1st and 2nd floors**

**6 Clinic Rooms**

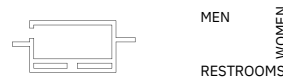

**NEW THIS YEAR!**

**CHECK THE MOST UP-TO-DATE BOOTH  
AVAILABILITY BY SCANNING THE QR CODE AT  
THE RIGHT**



**#LMEANOLA90**

**WWW.LMEAMUSIC.ORG**